



REPRO PRODUCTS

CAD Software ♦ Imaging Solutions ♦ Document Management

Locally owned and operated since 1979

www.reproproducts.com



**Reprographics,
Printing Services &
Document Management**



**Multi-function Office Devices,
Wide Format Equipment
Sales, Service & Supplies**



Autodesk Value Added Reseller

- AutoCAD, BIM, Infrastructure & Manufacturing Solutions
- Consulting & Implementations
- Autodesk Authorized Training Center



Digital Graphic Services

- Job Site Signage
- Vehicle Graphics
- Trade Show Displays
- Banners & Signage



REPRO PRODUCTS

CAD Software ♦ Imaging Solutions ♦ Document Management









Repro Products, Inc., established in 1979, was originally in the blueprint business. We are proud, though, to have evolved and expanded our expertise to include reprographic and color printing services, printers and copiers and Autodesk design software and training. Repro Products handles any size project from small format quick copying to wide format printing, while providing unparalleled service to our clients.

Our Imaging Solutions and Document Management Division offers sales and service of wide-format equipment from the top manufacturers – Xerox, Océ, Canon, Hewlett Packard and Kip - as well as multi-functional office devices from Xerox. Regardless of the size of your firm (or your budget), we have equipment and financing options to enable you to have on-site wide-format equipment and the latest office devices to increase your productivity.

“Repro Products and The Water Group have a 5-year history of working together. It is rare to find a company with whom such relationships last. Ours lasts because your people make every effort to always do their utmost best to satisfy the customer. If it were not for Repro Products, the work I perform for my clients would surely suffer in time delays. And, my work is always “time sensitive”. This means I look very good to my clients because Repro Products makes this possible.”

Mike Siravo,
The Water Group

Repro Products Services and Products Include:

-  Printing Services
-  Web-enabled Planroom
-  Wide Format Equipment
-  Media, Service & Support
-  Xerox Multi-Function & Production Devices
-  AutoCAD and Autodesk Software Solutions & Consulting
-  Autodesk Authorized Training Center
-  Digital Graphic Services at The Color Spot



Printing & Document Management Services

Repro Products can meet all your printing and scanning needs with our state-of-the-art Xerox equipment, including the Xerox Nuvera™ and Xerox ColorQube™ Multifunction printer. From reproduction to archiving to distribution, we have integrated digital services for all phases of your documentation. Repro Products has two convenient locations (Smyrna and North Fulton) as well as radio dispatched vehicles to provide dependable, quick turnaround throughout the metro Atlanta area. We handle any size project including small format quick copying, flat or folded flyers, proposals and more. Repro Products is proud to have printing specialists and graphic designers on staff who can assist you with all your printing and finishing needs.

“With other printing companies you seem to have a constant change of employees. It is great to keep working with the same Repro employees year after year and to be on a first name basis with them.”

Doug Fulcher, Chief Estimator,
Goodman Decorating Co., Inc.

Printing and Document Management Services:

Quick Copies and Small Format Color

Black & White and Color
Copy And Print 1-Sided Or 2-Sided Documents
Paper Weight and Finish Selection
Collate and Fold (Center and Tri-Fold)
GBC, Unibind And Spiral Binding
3 Hole Punch and Staple
Color prints up to 12"x18"

Large Format Black & White

Copy And Print Up To 36" Wide
Full and Half Sizes
Enlarge or Reduce Size
Print On Bond, Vellum, Film
Staple, Screw Post and Strip Binding

Large Format Scanning

Up To 42" Wide
Black & White and Color
File Types (.tiff, .pdf, .jpg)
Scan to CD, DVD, Thumb Drive or Email

Full Color Copy and Print

Print Up To 42" Wide
Papers (Coated Bond, Photo Gloss, Semi Gloss, Bond)

Digital Planroom

Online Listing Of Jobs
View, Track and Place Orders Direct From Site 24/7



We are confident you will agree that:



xerox



The right choice to meet your printing needs.

Wide Format Equipment

Engineering Equipment, Media, Service & Support

We are a major supplier of Xerox, Océ, Canon, Hewlett Packard and Kip and we carry toner, ink and media for the equipment we sell. Our award-winning wide-format equipment service staff has over 60 years of combined experience to keep your equipment up and running. Serving Architects, Engineers, Designers and Manufacturers for over 30 years has enabled us to provide the expertise and commitment that you require from a business partner.

"We have been a pretty steady customer at Repro Products now for many years in software and equipment purchases and training. Repro really came through with the purchase of our large format plotter, the HP T2300 when our old plotter "kicked the bucket". The new T2300 plotter was here and installed before we knew it so we weren't hurting in the production department very long. We really appreciate your efforts in this purchase."

Shevy Underwood,
Toland Mizell



Xerox® 6604™/6605™

- Print, copy and scan single footprint solution
- 15" color touch screen with preview capabilities
- On-board color capable scanner
- Up to 5 D-size prints per minute



HP Designjet T2300ps eMFP

- Print, copy and scan in B&W and color
- Create print-ready pdfs with a single click
- Print directly from your USB thumb drive
- Share print-ready files instantly



Océ PlotWave® 300

- Prints 4 D-size prints per minute
- Instant warm-up means instant printing
- USB® flash drive printing and scanning
- Top delivery stacks 50 E-size documents



Océ ColorWave® 300

- Print, copy and scan in B&W and color
- Prints 2 D-size color prints per minute
- Concurrent printing, copying and scanning
- Top delivery stacks and collates neatly



Canon iPF750

- 36-inch color printer
- High-speed output on a wide variety of media types
- High-quality printing up to 2400x1200 dpi
- Excellent for technical documents & full color graphics



Kip 7100

- Print, copy and scan in B&W and color
- Print speed up to 6 D-size prints per minute
- Built-in integrated USB port
- Integrated top stacking system



Xerox Multi-Function Devices



Repro Products is the only authorized Xerox agent in this geography and represents the entire Xerox line of printers and copiers from the smallest office device to wide format equipment to large production devices.



WorkCentre™ 5135/5150

- Optional Print, Scan, Fax, Email
- Up to 50 ppm
- Xerox-exclusive Print Around feature
- Automatic two-sided output standard



WorkCentre™ 7120

- Copy, Print, Scan-to-Email/Folder
- Up to 20 ppm color or black and white
- Xerox-exclusive Print Around feature
- Standard 2 GB memory



WorkCentre™ 7545/7556

- Copy, Print, Scan, Fax, Email
- Up to 50 ppm in color
- Best-in-class resolution of 1200 x 2400 dpi
- Easy to use color touch screen

XEROX ColorQube™



TIERED PRICING!!!
With the Xerox ColorQube™, your costs depend on the amount of color on each print.



“Hey Repro guys! Lovin’ the ColorQube. The colors, the speed, the ease of operation is awesome! We appreciate Repro helping us choose which printer would best meet our needs and we are enjoying the quality of this unit. The staff gives you a big thumbs up!”

Rev. Jeff Watkins,
New Covenant Church of God

Production Devices



Xerox 700 Digital Color Press

- Color Printing, Copying, Scanning
- Up to 70 ppm
- Highest resolution available ñ 2400 x 2400 dpi
- Automatically print 2-sided on coated paper



Color 550/560

- Print, Copy, Fax, Scan
- Up to 60 ppm in color
- Print everything from postcards to posters
- Booklet Making, Finisher, Stapler

CAD Software Services

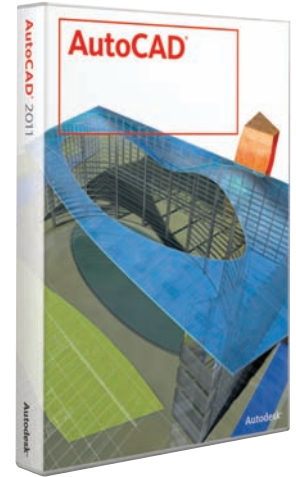
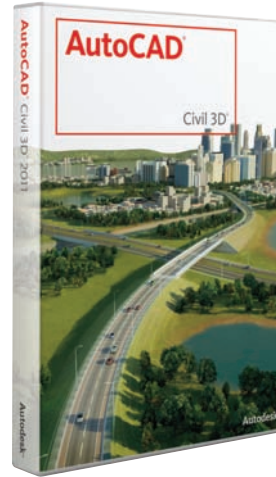
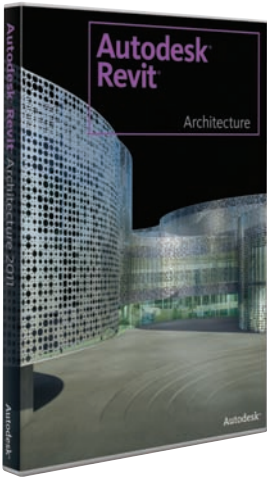

Repro Products' Software Division is dedicated to Autodesk software consulting, sales, training, implementations and support. As an Authorized Autodesk Value-Added Reseller since the late 80's, we utilize our depth of experience serving the architectural, infrastructure and manufacturing industries to provide expert guidance on Autodesk products from the assessment of client software needs, through the sale of the software to implementation, training and support. Our team of Business Development Managers and Applications Engineers are widely regarded as the premier Autodesk products professionals in the Southeast. Repro Products has highly trained Applications Engineers across all three verticals: Building, Infrastructure and Manufacturing Solutions providing consulting services which include implementation services, customization, integration and training.

Training

Get the greatest return on your software investment, faster, by building your knowledge in the areas you need the most at Repro Products, your Autodesk Authorized Training Center (ATC). In addition to the regularly scheduled training classes listed on our website, we offer a host of custom or project-specific Autodesk training programs either at our Learning Center or your office.

Key Benefits of Training at Repro Products:

- **Increase your competitiveness**
- **Find out about the latest productivity features**
- **Learn best practices**
- **Develop the skills you need to make the most of your Autodesk software**
- **Prepare for and take Certification Exams**

Autodesk®
Authorized Training Center

Autodesk Authorized Training Center (ATC)

Let Repro Products Show You How to Get Autodesk Authorized Training AND Get a Tax Credit

At the Repro Products' Autodesk Authorized Training Center, you can:

- Learn from highly qualified instructors at our superior facilities
- Receive Autodesk recommended content from Autodesk Official Training Guides
- Get your hands on sample projects and exercises that emphasize real-world application
- Choose a class, at the most appropriate skill level, to meet your needs
- Meet at a time that's convenient or sign up for custom, onsite training
- Earn a valuable certificate of completion that's recognized in your profession
- Validate your product knowledge by getting Autodesk Certified when you take a certification exam at Repro Products.



"The class was a great success. I have been using CAD since the class for a minimum of 2 hours a day. I was concerned going into it that it might be too general, or not cover enough, but it was excellent. I will certainly recommend the class to anyone needing training in the future."

**Kenneth White,
Kelmax Equipment**

AIA Continuing Education Providers

Many ATC courses are accepted by professional associations, including the American Institute of Architects (AIA). Ask Repro Products about earning credits for mandatory Continuing Education classes and other professional development programs.

Income Tax Credit

Let Repro Products work with you on a training program for your company which will both increase your employees' productivity and allow you to maximize your tax credits. We have worked with the Georgia Department of Technical and Adult Education to ensure our training meets the eligibility requirements for the Georgia Tax Credit for Retraining of Employees. An eligible business enterprise may be granted tax credits against its Georgia state tax liability:

- equal to 1/2 of the direct cost of retraining;
- up to \$500 per approved training program per year for each full-time employee who has successfully completed an approved retraining program;
- up to 50% of the amount of the taxpayer's income tax liability for the taxable year as computed without regard to this Code.

Autodesk®
Authorized Training Center

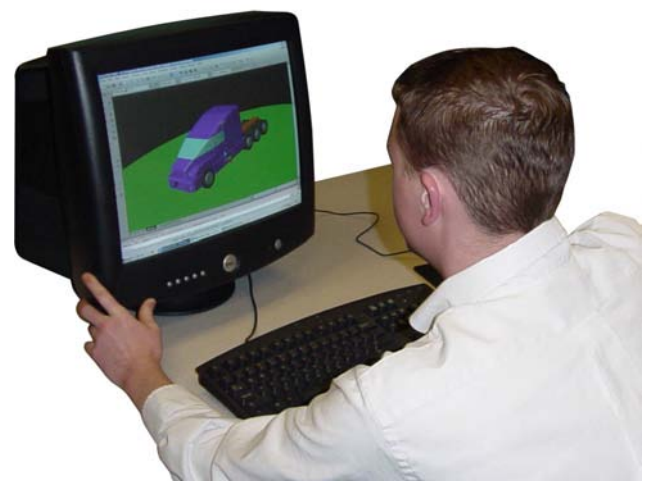

CAD Software Solutions

Repro Products can help you determine which solution is the best fit for your company, then provide the expertise to help you implement your new software. Our experts can assist you with an array of Autodesk products, including the following popular packages:

Platform Solutions

AutoCAD®

Design and shape the world around you with the powerful, flexible features found in AutoCAD® software, one of the world's leading 2D and 3D design applications. Help speed documentation, share ideas seamlessly, and explore concepts more intuitively in 3D. Powerful programming tools and thousands of available add-ons help you customize AutoCAD for your specific needs. It's time to take design further. It's time for AutoCAD software.

AutoCAD® LT®

AutoCAD® LT® 2D drafting and detailing software is the professional choice because we focus on boosting your productivity and enables you to accurately and efficiently create, document, and share your drawings. The genuine DWG™ file format provides stability and compatibility. Packed with powerful features, AutoCAD LT is built for professional drafting.



Architecture and Building Solutions

AutoCAD® Architecture

AutoCAD® Architecture is the version of AutoCAD® software for architects. Architectural drafting and documentation is more efficient with the software's intuitive environment and purpose-built tools for architects.

Autodesk® Navisworks®

With Navisworks solutions, detailed design models can be aggregated and reviewed by all project stakeholders, helping users to benefit from the competitive advantages of building information modeling (BIM) workflows.

Autodesk® Revit® Architecture

Autodesk® Revit® Architecture software helps architects and designers work naturally, design freely, and deliver projects efficiently. Purpose-built for building information modeling (BIM), Revit Architecture helps you capture and analyze design concepts, and more accurately maintain coordinated and reliable design data through documentation and construction.

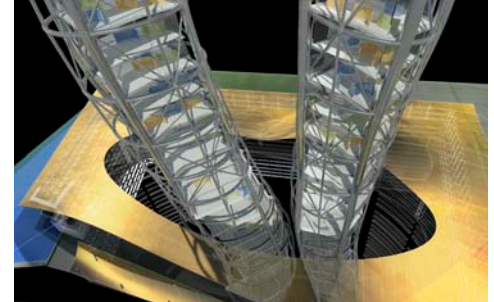

MEP Engineering Solutions

AutoCAD® MEP

AutoCAD® MEP software is the discipline-specific version of AutoCAD® software for mechanical, electrical, and plumbing (MEP) designers and drafters. AutoCAD MEP automates tedious drafting tasks, enabling designers and drafters to create more accurate construction documentation faster. Sharing, collaborating, and coordinating with architects, structural engineers, and contractors is easier using the software's reliable, widely used DWG™ file format.

Autodesk® Revit® MEP

Autodesk® Revit® MEP software is the building information modeling (BIM) solution for mechanical, electrical, and plumbing (MEP) engineers, providing purpose-built tools for building systems design and analysis.

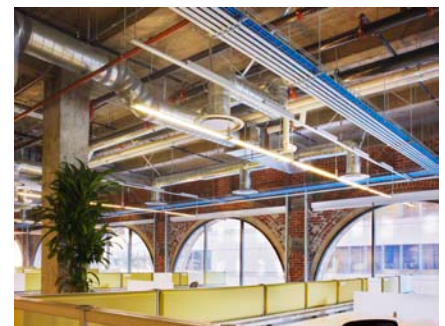

CAD Software Solutions

Civil Infrastructure Solutions

AutoCAD® Civil 3D®

AutoCAD® Civil 3D® software, the building information modeling (BIM) solution for civil engineering, helps teams deliver higher-quality transportation, land development, and environmental projects faster. Its model-based approach helps keep project information coordinated while delivering higher-quality documentation and visualizations. Gain the competitive advantage of BIM to deliver more innovative project solutions.



Geospatial Solutions

AutoCAD® Map 3D

AutoCAD® Map 3D software provides direct access to data needed for infrastructure planning, design, and management activities. AutoCAD Map 3D helps professionals working on transportation, land development, water, and power projects to more easily create, manage, and analyze design, GIS, and asset data. The results are better designs, enhanced productivity, and better data quality.



Manufacturing Solutions

AutoCAD® Electrical

AutoCAD® Electrical is AutoCAD® software for controls designers, purpose-built to accelerate the creation of electrical control systems by automating electrical engineering tasks and providing comprehensive symbol libraries.

AutoCAD® Mechanical

AutoCAD® Mechanical is AutoCAD® software for manufacturing, purpose-built to accelerate the mechanical design process by automating common tasks and providing comprehensive libraries of standards-based parts.

Autodesk® Inventor®

Autodesk® Inventor® software takes engineers beyond 3D to Digital Prototyping by giving them a comprehensive set of tools for 3D mechanical design that enables them to design, visualize, and simulate products before they are ever built. Digital Prototyping with Inventor software helps companies design better products, reduce development costs, and get to market faster.



Autodesk® Inventor LT™

Autodesk® Inventor LT offers the 3D part-level design capabilities of Autodesk Inventor, so you can take your design productivity to the next level, improve communication with your supply chain, and participate in Digital Prototyping workflows.

Autodesk® Navisworks® for Manufacturing

The Autodesk solution for Digital Prototyping moves your company beyond 3D modeling and enables manufacturing workgroups to create a single digital model that can be used in every stage of production, bridging the gaps that usually exist between conceptual design, engineering, mechanical design, electrical controls design, and manufacturing teams.

Repro Products and The Community

Repro Products and its employees devote both time and money to various educational and charitable organizations and have been honored by many institutions for their contributions to the community. Among these honors are:



One of the many nonprofit organizations supported by Repro Products is The Center for Family Resources (CFR) which incorporates both the ideals of family and community. CFR is committed to assisting low-income families with employment, education, and housing services; leadership development programs; mentoring opportunities; and temporary financial and food assistance. Repro Products organizes an annual food drive for CFR and was featured, along with their sister company, The Color Spot, Inc. on the front page of the Marietta Daily Journal for their contributions to the non-profit organization.

Kennesaw State University (KSU) and Southern Polytechnic State University (SPSU) have also both been enriched due to the involvement and resources of Repro Products and the Feldberg family. Two scholarships have been endowed at KSU for the College of the Arts by the Feldbergs, in addition to on-going involvement by the family in fund-raising activities for the University. The Feldbergs have also been very involved in the development of SPSU and Bob Feldberg has served on the board for Southern Poly.

Some of the many charities supported by Repro Products are listed below:

- | | |
|---|---|
| American Cancer Society | March of Dimes Walk America |
| American Heart Association | Marietta Fire Department |
| American Red Cross | Owen T. Wheeler Foundation |
| Angel Flight Inc | Partners in Education – Osborne HS |
| Atlanta 2day Walk for Breast Cancer | Partner in Education - South Cobb HS |
| Women’s Atlanta Day Shelter | Parkinson Disease Association, Atlanta Chapter |
| Big Brothers Big Sisters of Metro Atlanta | Powder Springs Youth Baseball |
| Boys & Girls Clubs of Cobb County | Ronald McDonald House |
| Center for Family Resources | Smyrna Fire Department |
| Children’s Healthcare of Atlanta | Southern Polytechnic State University Foundation |
| Citizens for Cobb | Special Olympics Georgia |
| Cobb Youth Leadership | Susan G Komen Breast Cancer |
| Cystic Fibrosis Foundation | Skanska/United Way |
| Dana Farber Cancer Institute | The AI Copeland Foundation |
| Dream Makers Youth Foundation | The Boy Scouts of America |
| Jimmy Fund Walk | The Cottage School |
| Juvenile Diabetes Research Foundation International (JDRF) | The Leukemia & Lymphoma Society |
| Kennesaw Mountain HS Booster Program | The Salvation Army |
| Kennesaw State University College of the Arts | Wellstar Community Hospice Board of Advisors |
| Leukemia & Lymphoma Society | Wellstar Foundation |
| Lekotek of Georgia | Wisconsin Historical Foundation |
| Marietta Kiwanis | YMCA |
| | YWCA of Northwest Georgia |

The Color Spot

1199 Atlanta Industrial Drive
Marietta, GA 30066
www.colorsportink.com
678.385.2188

The Color Spot, originally a division of Repro Products, was created to answer our customers' needs and graphic requirements by providing creative solutions from concept to completion. Our team can help businesses recognize their full potential with state-of-the-art solutions. When it comes to presenting a message in the newest and most stimulating ways, nobody gives you more than The Color Spot.

The Color Spot provides digital graphic services by utilizing the highest-quality media. We offer many services including:

Graphics, Displays, and Banners

- Trade Show
- Retail/POP – Wall/Floor/Window
- Indoor, Outdoor, & Boulevard Banners
- Wayfinding Signage



Vehicle Graphics

- Automobiles & SUVs
- Buses, Vans, & Delivery Vehicles
- Specialty – Boats/Planes/Motorcycles



Finishing

- Custom Mounting & Laminating
- High Resolution & Large Format Scanning
- Installation & Removal



DESIGN • PRINT • INSTALL



REPRO PRODUCTS

CAD Software ♦ Imaging Solutions ♦ Document Management

Corporate Office & Training Facility
770-434-3050
4485 Atlanta Rd
Smyrna, GA 30080

North Fulton Reprographic Center
770-408-1880
645 Hembree Park Dr, Suite H
Roswell, GA 30076

AGC Plan Room
678-298-4130
1940 The Exchange, Suite 300
Atlanta, GA 30339

www.reproproducts.com



The Color Spot
678-385-2188
1199 Atlanta Industrial Drive
Marietta, GA 30066
www.colorsportink.com